

4G Stick Logger Quick Installation Guide

For Global Region(Except China)



4G Stick Logger Quick Guide

Notice:

Please read this manual carefully before using the Loggers and keep it in the place where O&M personnels can find it easily.

The content of this manual is subject to change without notice due to product upgrade and other factors, and get the latest manual from www.solarman.cn or sales. Unless otherwise agreed herein, this manual will only be used as guidance. Any statement, information or suggestion in this manual will not incur any form of responsibility.

Without written permission, any content of this document (partly or entirely) cannot be extracted, copied or transmitted in any form by any company or individual.



Warning:
Please remove logger after power off.

Download APP



SOLARMAN Smart
for end user



SOLARMAN Business
for business

iPhone: Search "SOLARMAN Smart" in Apple Store.
Android: Search "SOLARMAN Smart" in Google Play.

Install SIM Card

Notice: If the product you purchased integrated with SIM card, this procedure is not required.

Step 1:

Remove antenna and bottom cover in order, then pull out circuit board. (Please keep waterproof grommet of antenna and bottom cover well.)

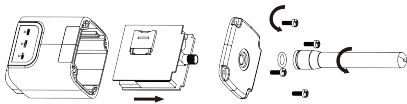

Step 2:

Move upper sheet-metal of SIM card slot about 1mm according to arrow direction, then open it counter-clockwise.

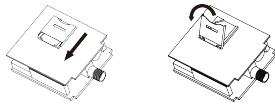

Step 3:

Put SIM card into the slot according to notch orientation, close sheet-metal of SIM card slot clockwise, then move about 1mm according to arrow direction to lock.

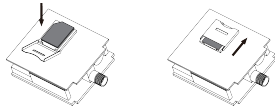

Step 4:

Put circuit board into the enclosure, then push it down along the inner guide. (Please keep SIM card face the indicator light.)

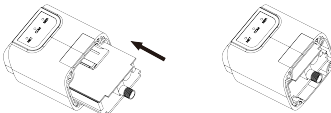

Step 5:

Install waterproof grommet of bottom cover properly, then install bottom cover. Tighten screws clockwise.

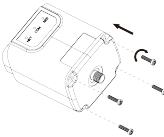

Step 6:

Install waterproof grommet of antenna on the antenna base, then tighten antenna clockwise.

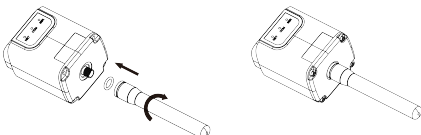

1. Stick Logger Installation

Type 1

Step1: Assemble logger to the inverter communication interface as shown in the diagram.

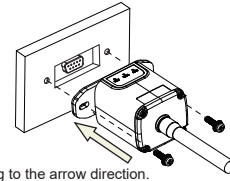

According to the arrow direction.

Step2: Install/Remove

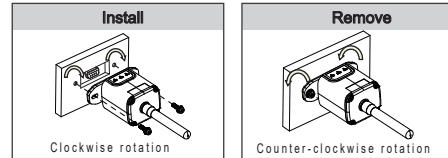

Warning:
Please do not hold the logger body to rotate while install or remove the logger.



Type 2

Step1: Assemble logger to the inverter communication interface as shown in the diagram.

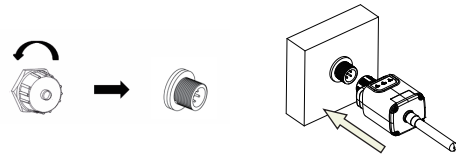

Step2: Install/Remove

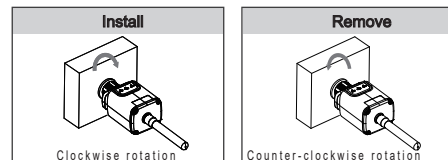

Warning:
Please do not hold the logger body to rotate while install or remove the logger.



2. Logger Status

2.1 Check Indicator light

Lights	Implication	Status Description(All lights are single green lights.)
NET	Communication status with base station	1.Light on 200ms/Light off 1800ms(Slow flash): 4G module connected to base station. 2.Light on 1800ms/Light off 200ms(Fast flash): 4G module is idle. 3.Light on 125ms/Light off 125ms(Fast flash): 4G module transmitting data. 4.Light off: 4G module not running.
COM	Communication status with inverter	1.Light keeps on: Successful connection to the inverter. 2.Light on 400ms/Light off 1600ms(Slow flash): Initialization. 3.Light on 400ms/Light off 400ms(Fast flash): Data transmission with inverter. 4.Light off: Communication with inverter failed.
SER	Communication status with server	1.Light keeps on: Successful connection to the server. 2.Light on 400ms/Light off 1600ms(Slow flash): Initialization. 3.Light on 400ms/Light off 400ms(Fast flash): Connection with server failed.

The normal operation status of the stick logger with good base station signal:

- 1.Initializing: COM&SER light flash slowly after the stick logger powered on;
- 2.Registering: NET light flashes (On 200ms/Off 1800ms) around 50s;
- 3.Successful communication with inverter: COM light flashes fast three times around 53s;
- 4.Successful registration on network: NET light flashes (On 1800ms/Off 200ms) around 83s, ready to send data;
- 5.Normal operation: COM&SER light keep on and NET light flashes (On 125ms/Off 125ms) around 150s.

Notice: Blink time of indicator lights will change according to network status on site.

3.Abnormal State Processing

If the data on platform is abnormal when the stick logger is running, please check the table below and according to the status of indicator lights to complete a simple troubleshooting. If it still can not be resolved or indicator lights status do not show in the table below, please contact Customer Support.
(Note: Please using the following table query after power-on for 2min at least.)

NET	COM	SER	Fault Description	Fault Cause	Solution
● NET	● COM	● SER			
Any state	OFF	Any state	Communication with inverter abnormal	1.Connection between stick logger and inverter loosen. 2.Inverter does not match with stick logger's communication rate.	1.Check the connection between stick logger and inverter. Remove the stick logger and install again. 2.Check inverter's communication rate to see if it matches with stick logger's.
Flash	On/Flash	Flash	Communication with base station abnormal	1.SIM card is in arrears 2.Antenna abnormal 3.4G signal strength weak.	1.Check if SIM card balance is sufficient. 2.Check the antenna, if there is any damage or loose. 3.Base station signal problem. It is suggested to change sucker antenna.
OFF	OFF	OFF	Power supply abnormal	1.Connection between stick logger and inverter loosen or abnormal 2.Inverter power insufficient. 3.Stick Logger abnormal	1.Check the connection, remove the stick logger and install again. 2.Check inverter output power. 3.Contact Customer Service.

3.Add a Logger

Method 1: Enter logger SN manually.
Method 2: Click the icon in the right and scan to enter logger SN
You can find logger SN in the external packaging or on the logger body.

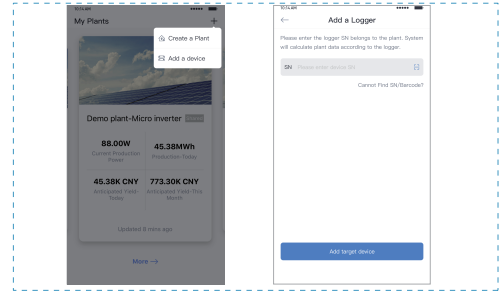

Warning: Please make sure the stick logger is working properly before you leave the site. If there is anything abnormal, please do not leave the site and contact customer service at the first time.
Customer Hotline: +86 400 181 0512
Support E-mail: customerservice@solarmanpv.com

If you have any technical queries about our products, please contact us and provide the following information:
1. Product model and serial number of stick logger.
2. Product model and serial number of connected inverter.
Thank you for your support and cooperation!

USER MANUAL for SOLARMAN Smart APP

1.Registration

Go to SOLARMAN Smart and register.
Click "Register" and create your account here.

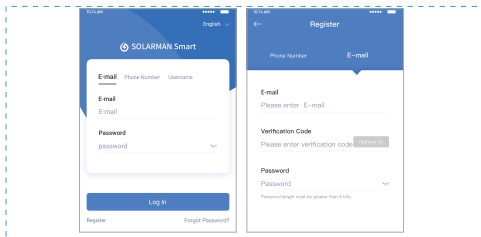

2.Create a Plant

Click "Add Now" to create your plant.
Please fill in plant basic info and other info here.

