



M | Monitoring APP Guide

For On-grid Inverters



1. APP Download

- 1) Scan the QR code below to download the SOLARMAN Smart APP, or
- 2) Go to App store on your phone and search 'SOLARMAN Smart' to download the SOLARMAN Smart APP.



2. Wifi Stick Logger Installation

- 1) Fix the stick to the Wifi port on the inverter, and
- 2) Rotate the front operative part of the stick clockwise till the secure connection of the stick.

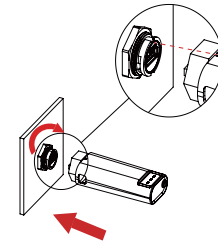

Then the logger will communicate with the inverter automatically.

3. Wifi Network Configuration

- 1) APP Logging In
If you are a new user, please register a new account first.

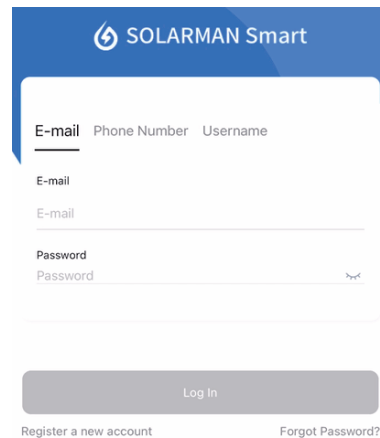

- 2) Create a Plant
Tap 'Add Now' to create your plant.
Fill in plant basic info and then tap 'Done'

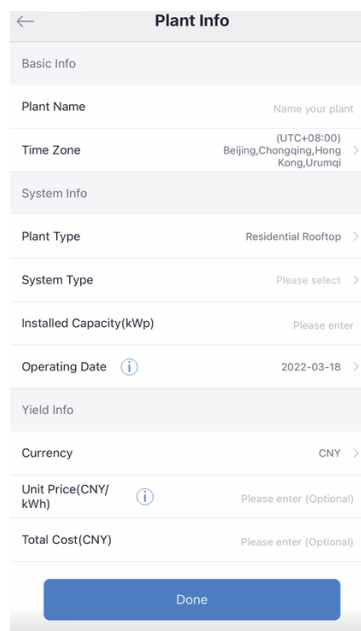
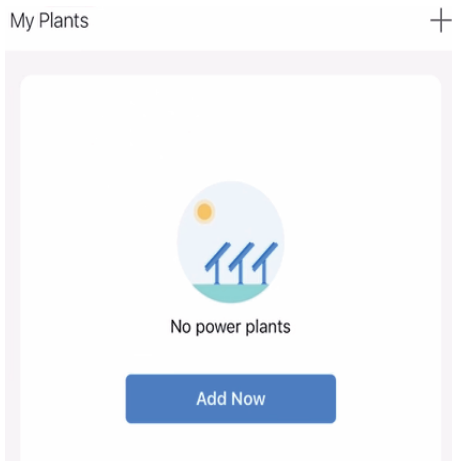

3) Add Inverters Loggers to the Plant You Created



Note: Please turn on the Bluetooth on your phone and prepare the correct password for the Wifi you want to use when you configure the network for the Wifi stick logger!

There two ways to add Wifi stick logger:

- a. Enter the SN code on the Wifi stick logger manually, or
- b. Tap the scan icon and scan the QR on the logger

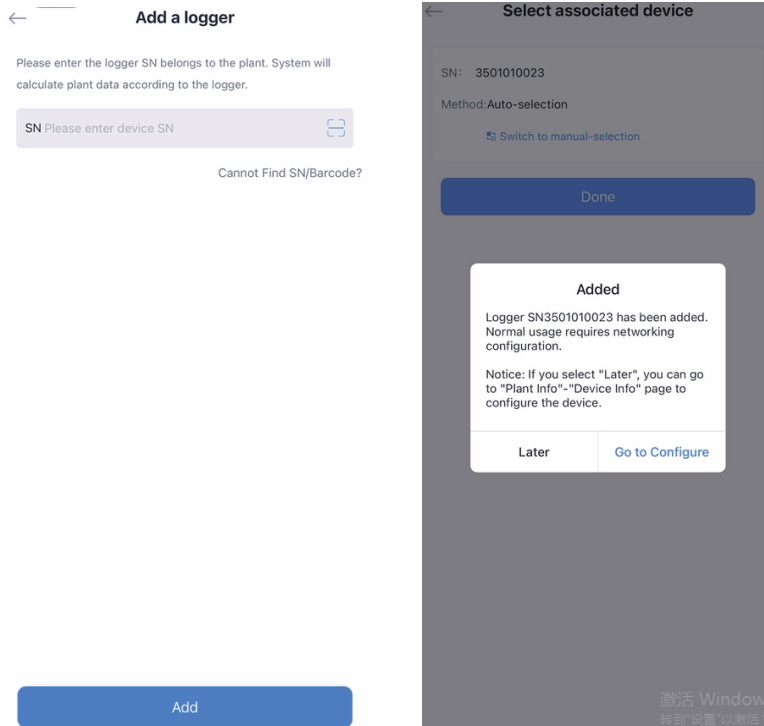

4) Wifi Configuration for Stick logger

- a. Choose the wifi network you want to use and enter the correct password
- b. Tap 'Start to Configuration' and wait around one minute for the process

Please enter Wi-Fi password

5G frequency band is not supported. Please connect to 2.4G frequency band.

EACH_RD_TEST

Change network

Require a password?



Comm2021



Start to configure

Countdown

59



Please shorten the distance between the device, router and phone.



Note: Your Wifi should be 2.4GHz Wifi, and 5GHz Wifi is not supported.

5) Power Generation Check

Check the power generation statistic in the following page.

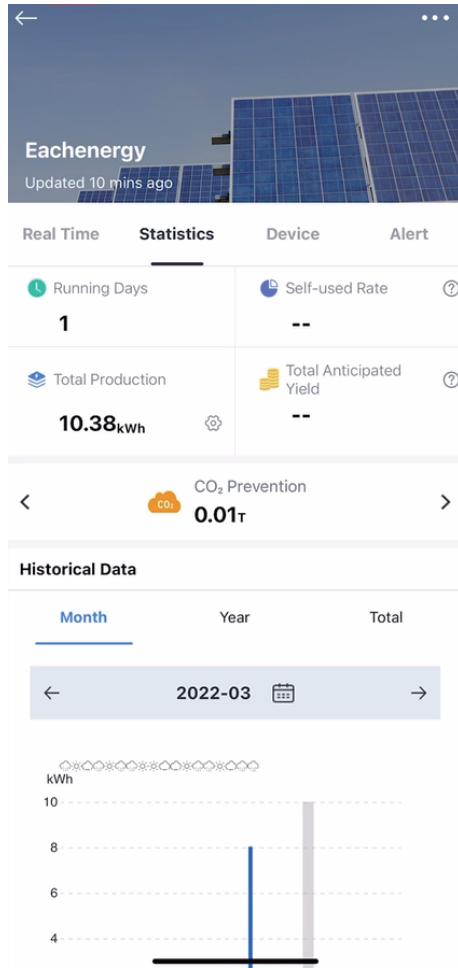

4. Plant Statistics Display



Real Time Statistics Device Alei

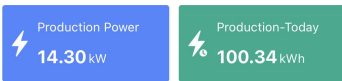

24-hour Trend

← 2022-07-28 →

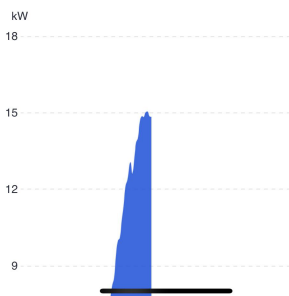

4.1 Real Time:

The Production Power, Production Today, 24-hour Trend are displayed here



Real Time Statistics Device Alei

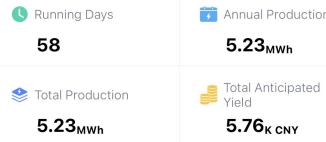

← Trees Planted 14.31 Tree(s) →

Historical Data

Month Year Total

← 2022-07 →

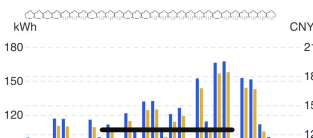

4.2 Statistics:

Running Days, Annual Production, Total Production, Total Anticipated Yield and Historical Data are displayed here.



4.3 Device:

4.4 Alert:

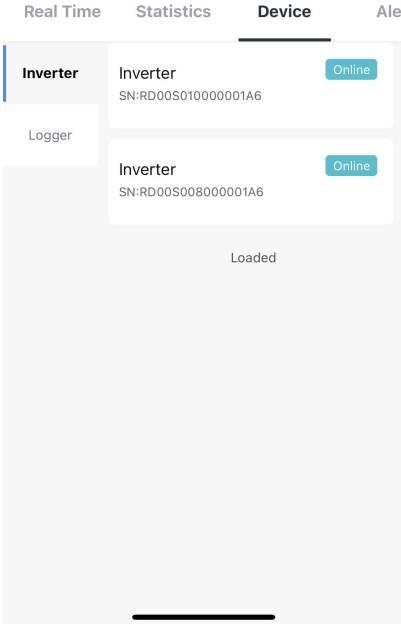

Detail info. of inverter and logger are displayed here.

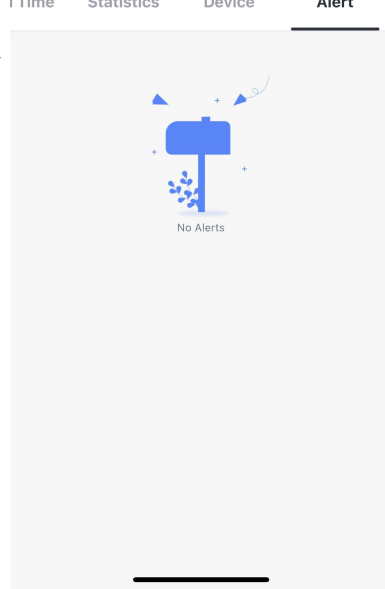

Alert info. of warning or fault is displayed here.

5. Logger Indicator Lights

Lights	Functions	Light Status Description
<p>NET</p>	Communication with router	1. Light off: Connection to the router failed 2. On 1s/Off 1s(slow flash): Connection to the router succeeded 3. Light keeps on: Connection to the server succeeded 4. On 100ms/Off 100ms(Fast flash): Distributing network fast
<p>COM</p>	Communication with inverter	1. Light keeps on: Logger connected to the inverter 2. Light off: Connection to the inverter failed 3. On 1s/Off 1s (slow flash): Communicating with inverter
<p>READY</p>	Logger running status	1. Light off: running abnormally 2. On 1s/Off 1s (slow flash): unning normally 3. On 100ms/Off 100ms(Fast flash): Restore factory settings