

# Quick Installation Guide

## EET75KPro-110K - M1

### ① Overview

#### 1.1 Scope of Delivery

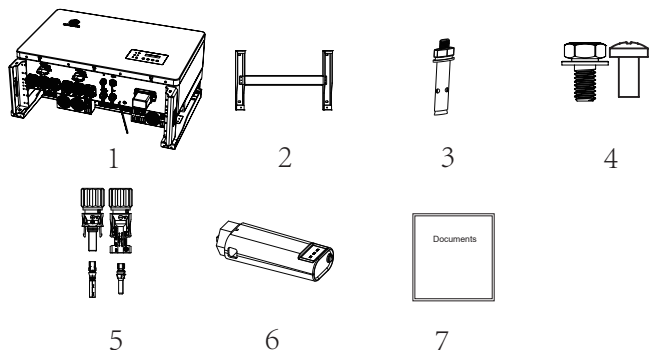

No.	Description	Quantity
1	Inverter	1
2	Wall Bracket	1
3	Expansion Screws	4
4	Fastening Screws	3
5	DC Connectors	18Pairs
6	WiFi/GPRS Stick	1
7	Documents	1

#### 1.2 Port Description

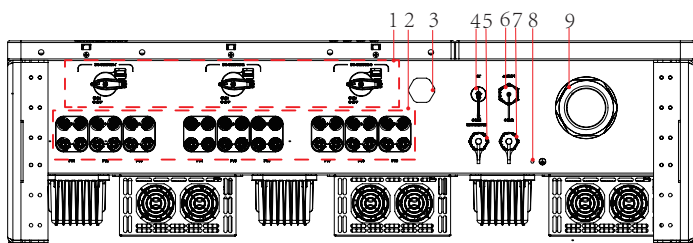

No.	1	2	3	4	5	6	7	8
Name	DC Switch	PV Ports	Reserved	CT Port	COM/Meter /DRM	Wifi/GPRS	Communication Port 2	Grounding Port
No.	9							
Name	AC Port							

### ② Mechanical Installation

#### 2.1 Installation Requirement

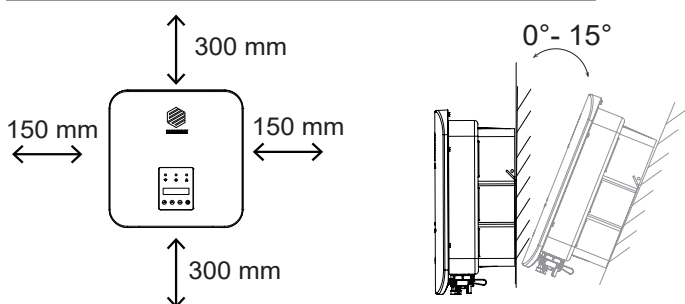

- 1) A minimum 150 mm clearance should be kept between two inverters and a minimum 300 mm clearance between inverters and the ground.
- 2) Install inverter vertically or with a backward tilt within 15°.



#### Warning

Do not select locations storing flammable material, which may cause fire or explosion!

#### 2.2 Mounting

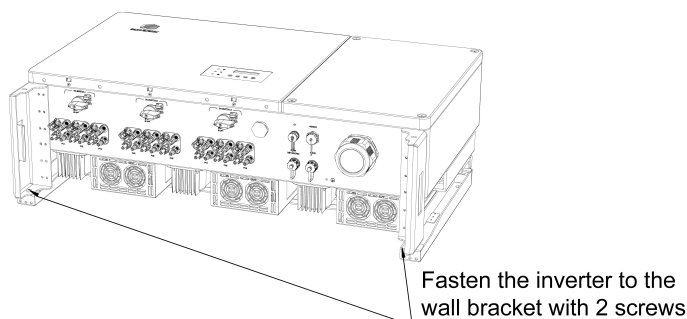
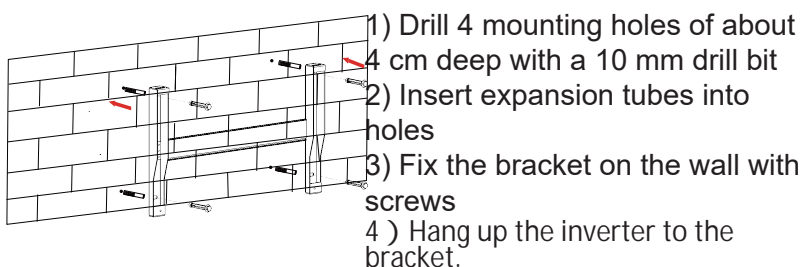

## 2.3 Wifi/GPRS Stick Logger Installation

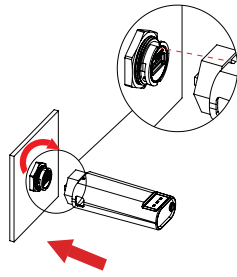

- 1) Plug the stick to the Wifi port on the inverter
- 2) Rotate the front operative part of the stick clockwise till the secure connection of the stick.

## ③ Electrical Connection

### 3.1 Assemble DC connectors

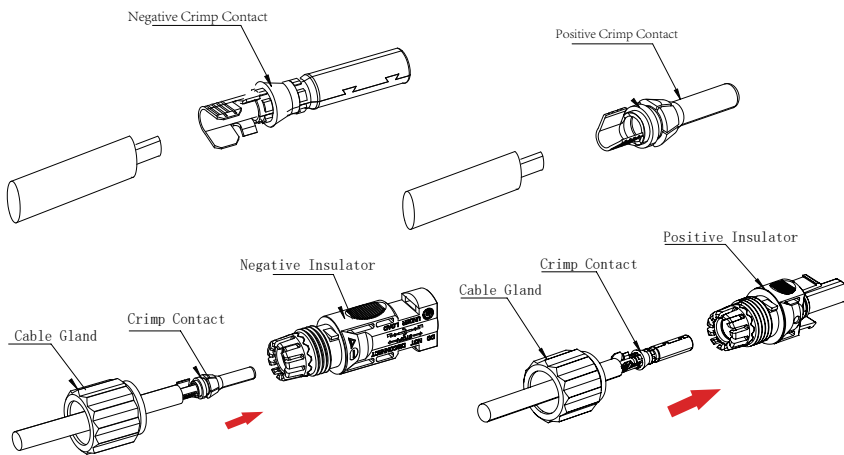

### 3.2 Install DC connectors to Inverters

- 1) Turn the Grid Supply Main Switch OFF.
- 2) Turn the DC switch OFF.
- 3) Connect the DC connectors to the Inverter, small click confirms connection.

3) Remove the front cover of the AC Junction Box, and insert the AC cable to the AC terminal block through the AC Port.

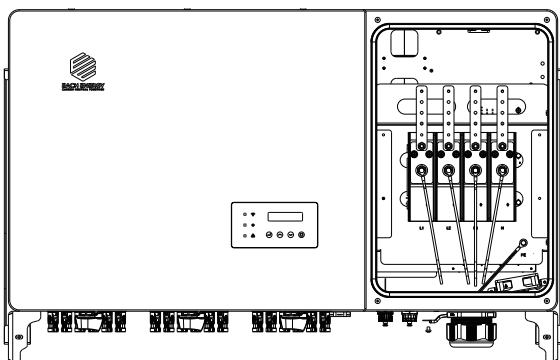

## 2.4 External Grounding Connection

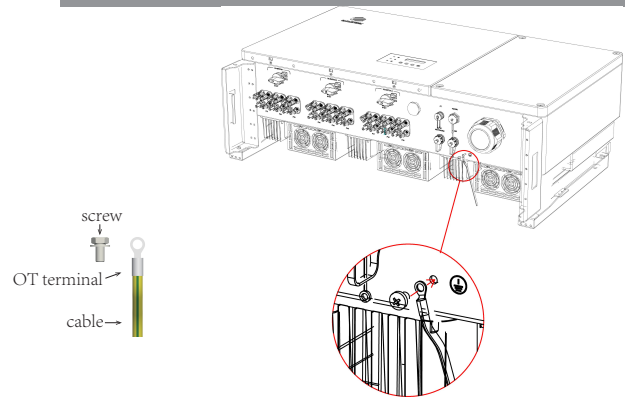

- 1) Crimp a grounding cable to the OT terminal
- 2) Insert a fastening screw into the OT terminal
- 3) Insert them to the grounding port of the inverter
- 4) Screw them together.

- 1) Strip off the DC Cable for a little length.
- 2) Insert the wire into the Crimp Contact and crimp them with an electrical crimp-er.

- 3) Thread the cable through the Cable Gland, insert it into the insulator, and gently pull back the cable to ensure firm connection.
- 4) Then screw up the Cable Gland to the Insulator.

### 3.3 AC Side Connection of Inverters

- 1) Prepare AC cable by crimping the wires into OT terminals as illustrated in the following diagram,  $A1 \geq A2$ .

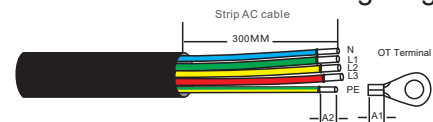

- 4) Fasten the L1, L2, L3 and Neutral AC wire to the corresponding terminal block, and the grounding wire to the grounding port.

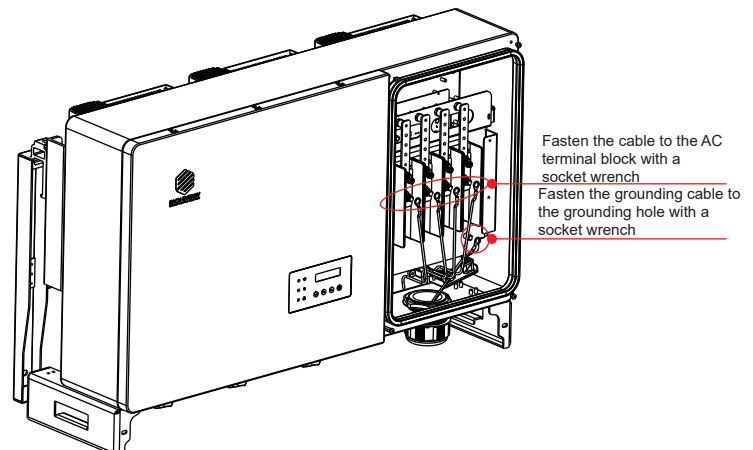

Fasten the cable to the AC terminal block with a socket wrench  
Fasten the grounding cable to the grounding hole with a socket wrench